

TEXAS HISTORICAL COMMISSION

real places telling real stories

DECLARATION OF DEDICATION FOR CEMETERY PURPOSES FOR THE WOMACK-WHITE CEMETERY

THE STATE OF TEXAS

§
§
§

KNOW ALL MEN BY THESE PRESENTS:

COUNTY OF BOSQUE

That the Texas Historical Commission, an agency of the State of Texas, does hereby certify and declare:

That the Womack-White Cemetery, located in the C.S. BROWN SURVEY, ABSTRACT NO. 89, Bosque County, Texas and more particularly described in Exhibit A as attached hereto, has been set aside and dedicated for cemetery purposes through historic use and that such property is now occupied by human graves.

That the Texas Historical Commission has duly considered the evidence of existence and historic use of said cemetery and has listed said cemetery as a Historic Texas Cemetery, worthy of preservation.

That this dedication is subject to all the laws, rules, and regulations of the State of Texas regarding cemeteries now in effect and to those adopted after the effective date of this dedication, and is made in accordance with 13 Tex. Admin. Code Section §21.30.

This Affidavit of Dedication for Cemetery Purposes is signed and executed on this 20 day of July, 2011.

[Handwritten signature of Terry Colley]

Terry Colley
Deputy Executive Director
Texas Historical Commission

THE STATE OF TEXAS

§
§
§

COUNTY OF TRAVIS

BEFORE ME, the undersigned authority, on this day personally appeared Terry Colley, known to me to be a credible person, whose name is above subscribed, and said person swore to me the statements contained herein are true and correct.

SUBSCRIBED AND SWORN TO BEFORE ME on this 20 day of July, 2011.

[Handwritten signature of Annette Bethke]

NOTARY PUBLIC in and for the STATE OF TEXAS

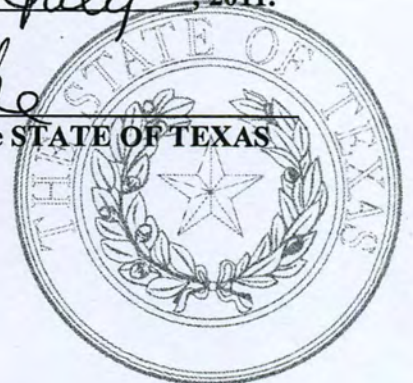
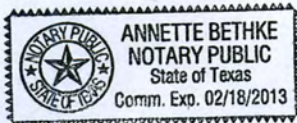

Location Map

Exhibit A

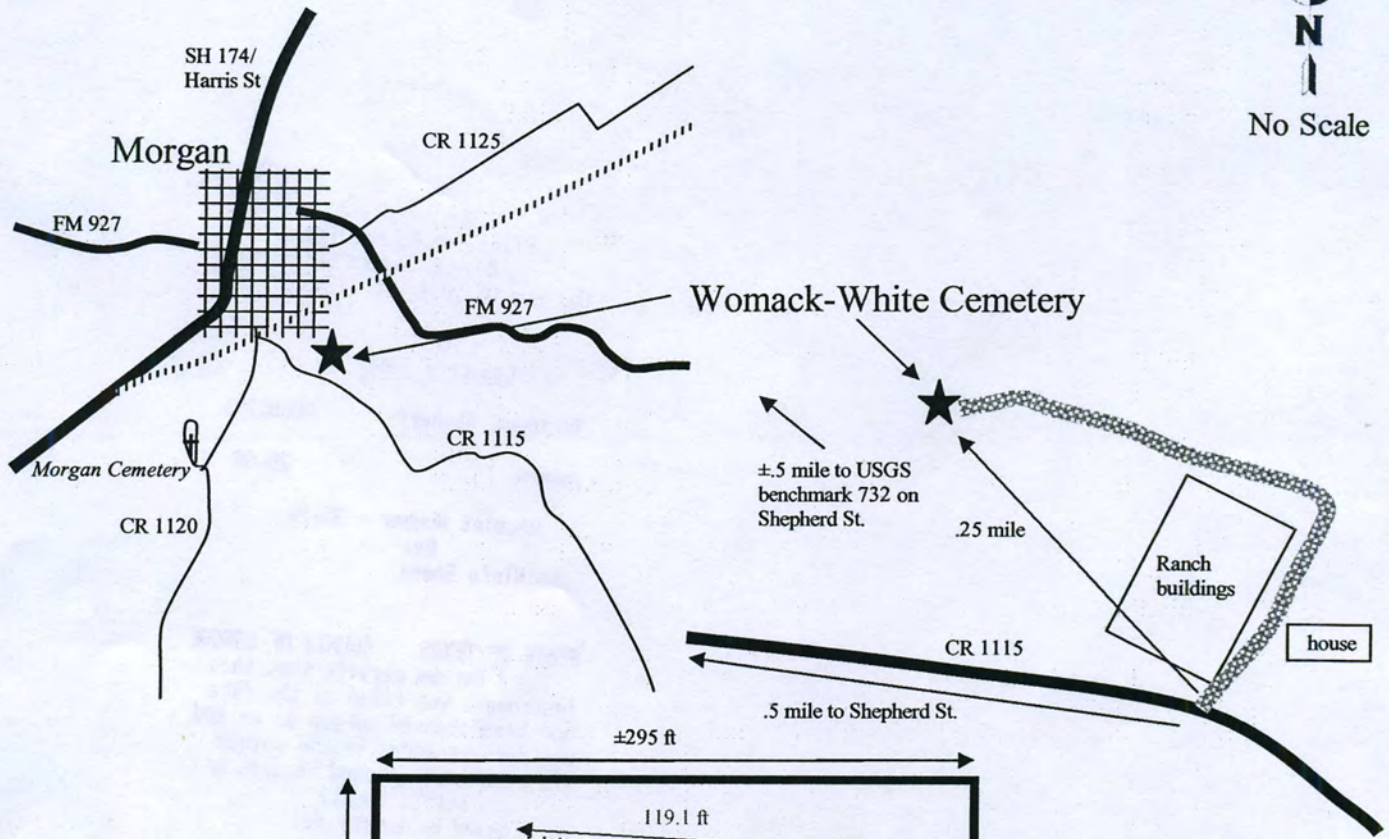

Surrounding Landowner:  
Taylor & Flonnie Payne

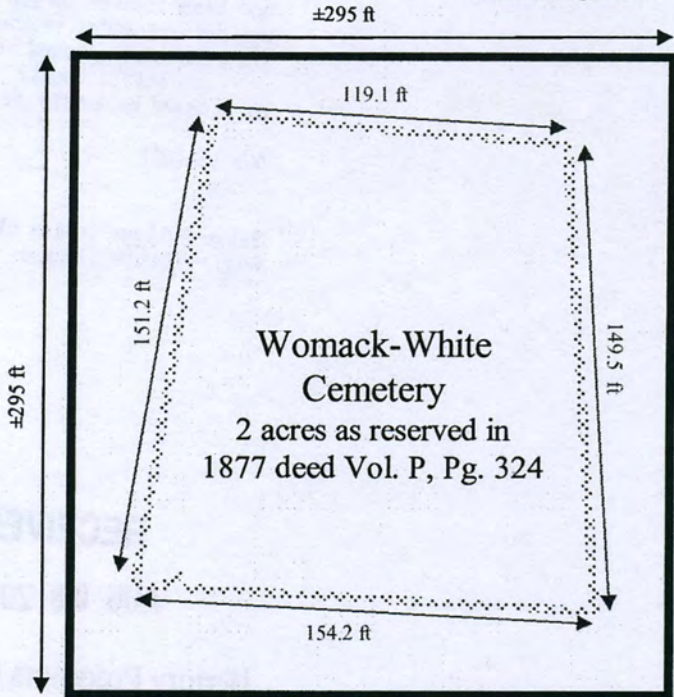

Detail Map

**1314 CR 1115, MORGAN TX**

Map adopted from data provided by the applicant and Texas Cemetery Restoration LLC  
See Deed Records of Bosque County, Vol. P, Pg. 324  
Located in the C.S. Brown Survey A-89, Bosque County, Texas.  
Latitude: 32.00839 N Longitude: -97.60173 W (NAD83).

**WOMACK-WHITE CEMETERY**

Also known as the White-Womack Cemetery  
Cemetery No. BQ-C003  
Bosque County

No. 2-115

Filed for Record in:  
Bosque County  
On: Aug 03, 2011 at 12:55P

As a  
Cemetery Deed

Document Number: 00002296

Amount 20.00

Receipt Number - 25126  
By:  
Ninfa Gomez

STATE OF TEXAS COUNTY OF BOSQUE  
I hereby certify that this  
instrument was filed on the date  
and time stamped hereon by me and  
was duly recorded in the volume  
and page of the named records of:  
Bosque County  
as stamped hereon by me.

AUG 03, 2011

Betty Outlaw, County Clerk  
Bosque County Clerk

**RECEIVED**

**AUG 08 2011**

**History Programs Division**

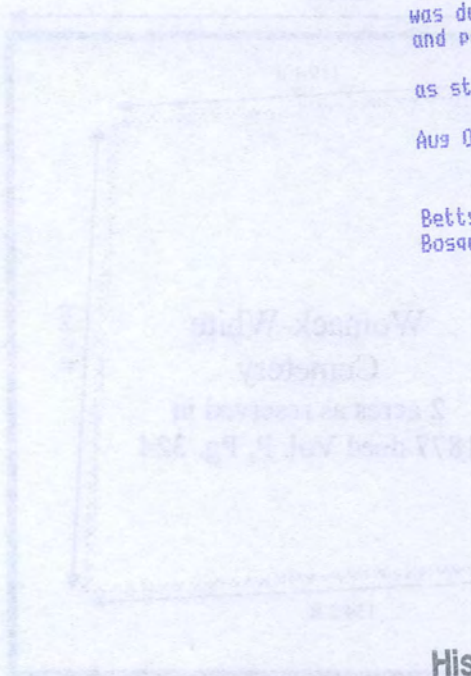
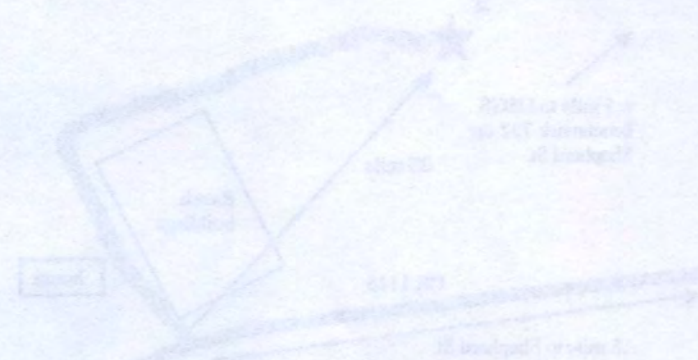

Map adapted from data provided by the applicant and Texas Cemetery Association LLC  
See land records of Bosque County, Vol. P, Pg. 324  
located in the U.S. Brown Survey A by Bosque County, Texas  
Latitude: 35.088874 Longitude: -101.002174 (GAD83)  
**WOMACK-WHITE CEMETERY**  
Also known as the White Womack Cemetery  
Cemetery No. 0001  
Bosque County